

# Smart Security Panel Kit

## **User Manual**

# CONTENT

I.	General Description.....	1
1.1	Product Example.....	1
1.2	Home Installation Diagram.....	2
II.	Set up Smart Life APP .....	3
2.1	Download APP - Smart Life .....	3
2.2	Connect Panel to Smart Life APP .....	3
2.3	Settings on APP .....	7
III.	Set up the Security Devices .....	9
3.1	Security Panel .....	9
3.2	Entry Sensor.....	11
3.3	Motion Sensor.....	13
3.4	Controller.....	14
3.5	Multifunction Button---Doorbell/SOS Button .....	15
IV.	Learn to Use the Security Panel.....	16
4.1	Main Interface .....	16
4.2	Menu introduction.....	17
4.2.1	Accessory .....	17
4.2.2	Phone.....	18
4.2.3	Security.....	20
4.2.4	Settings.....	21
V.	Troubleshooting and Maintenance .....	22
VI.	Hazardous Substance Declaration.....	23
VII.	Warranty Rules .....	23

# I. General Description

## 1.1 Product Example

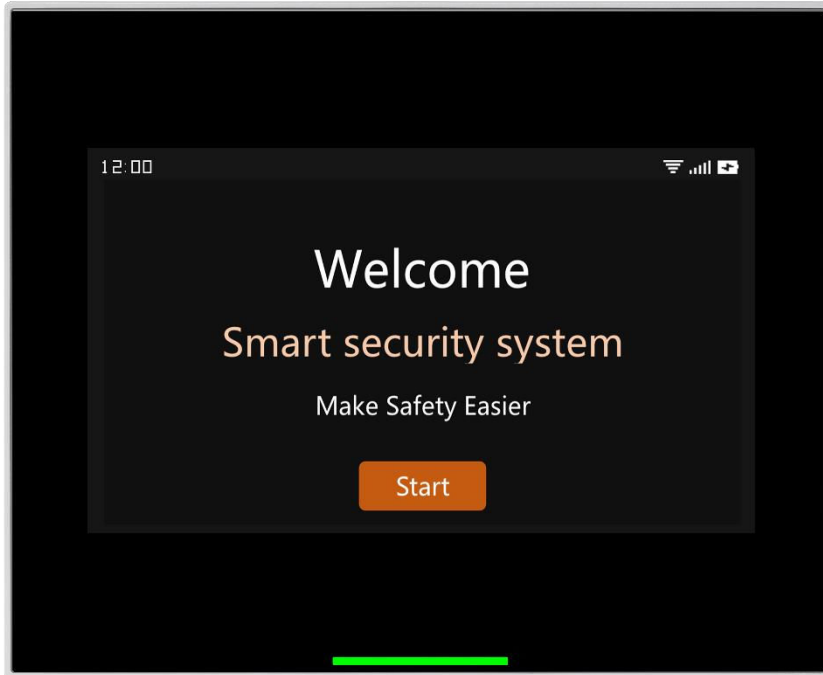

**Security Panel**

The central hub of the security system. Using 4.3-inch IPS capacitive touch screen, built-in high-performance low-power intelligent microprocessor. The security panel can be wirelessly connected to motion sensors, entry sensors, smoke detectors, gas detectors, emergency buttons, controllers, and other accessories. It connects all of your accessories to the APP, so you can stay in control of your home from anywhere.

Accessories list: (Subject to actual packaging)

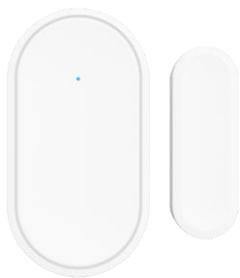

**Entry Sensor**

Send the alarm signal to the panel when the door or window are opened, it is recommended to install at important entrances.



**Motion Sensor**

Send the alarm signal to the panel when the movement is detected.



**Controller**

After pairing with the security panel, quickly "Away", "Home", and "Disarm" the security system, and trigger the emergency alarm.

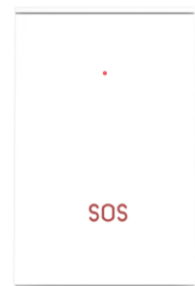

**Multifunction Button**

Doorbell button or SOS button

## 1.2 Home Installation Diagram

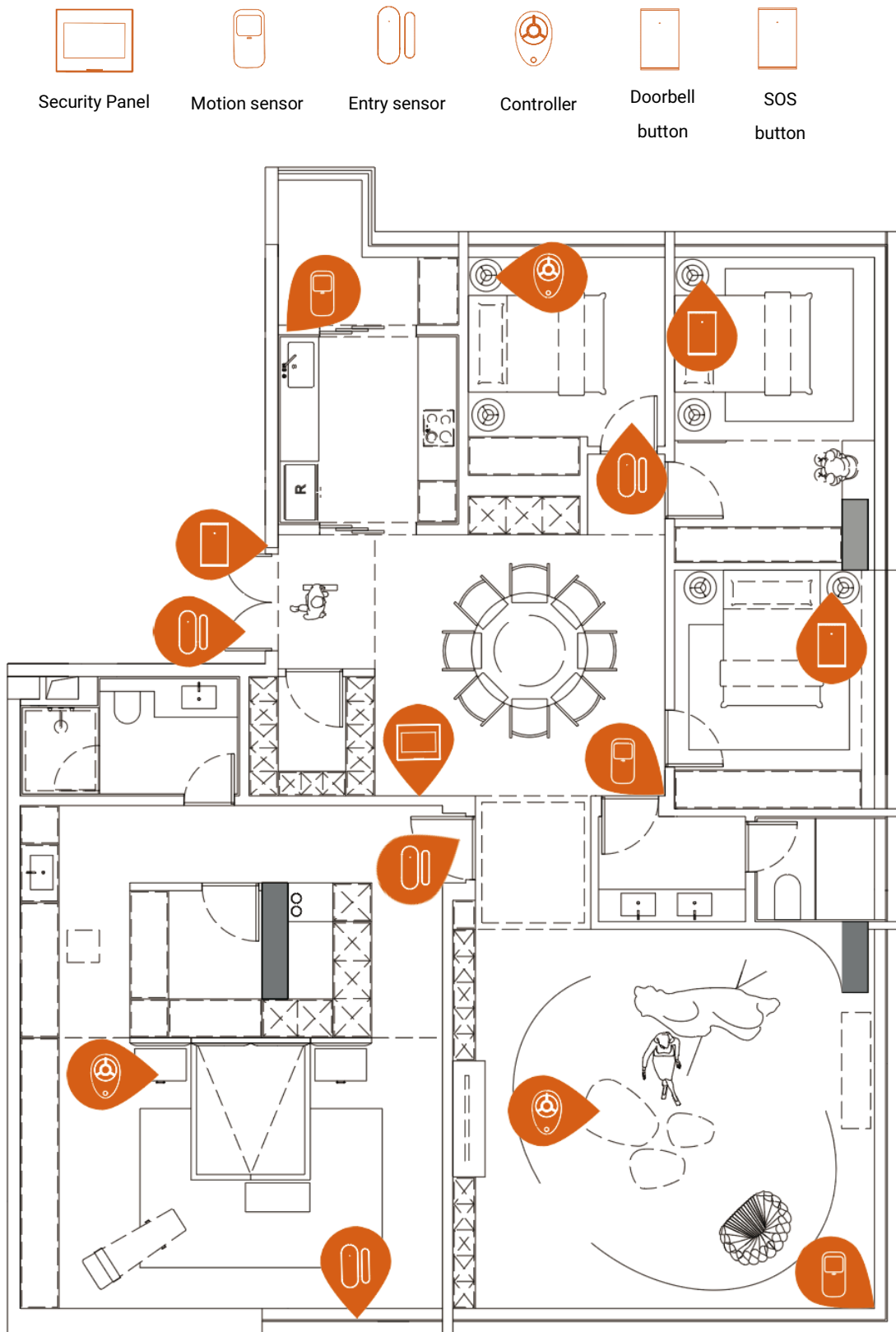

## II. Set up Smart Life APP

### 2.1 Download APP - Smart Life

**Note:**

Turn on the panel, choose a language, and scan the QR code on the panel to download;

Users can also search "Smart Life" in major global APP stores or scan the QR code below to download.



Apple APP Store



Google Play Store

- (1) iOS users, please scan the [Apple APP](#) QR code.
- (2) Android users, please scan the QR code of [Google Play](#) to download.
- (3) After downloading the APP, please enable all usage permissions for the APP in the phone settings.
- (4) Sign up or Log in to your APP account.

### 2.2 Connect Panel to Smart Life APP

**Note:**

- (1) This security panel only supports 2.4GHz WiFi networks only. Make sure your router is set up correctly and can connect to the Internet.
- (2) When adding the security panel to the Smart Life APP, please turn on the mobile phone WiFi and Bluetooth, and confirm that the mobile phone is connected to the 2.4GHz frequency band.

**Steps:**

- (1) For first-time use, please connect the security panel to the power supply, and turn the backup battery switch on the back of the panel to the "ON" position.

If you have entered the main interface or want to reset the WiFi, please click "Menu"---"Settings"---"WiFi", and enter the default user code: 1234. It will enter the WiFi setup "Step 1".

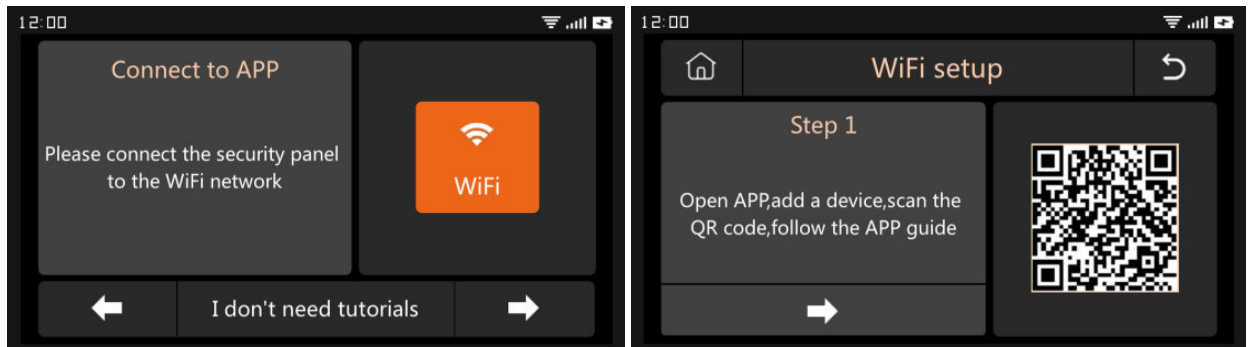

- (2) **On APP:** Open the "Smart Life" APP and enter the "Home" interface.

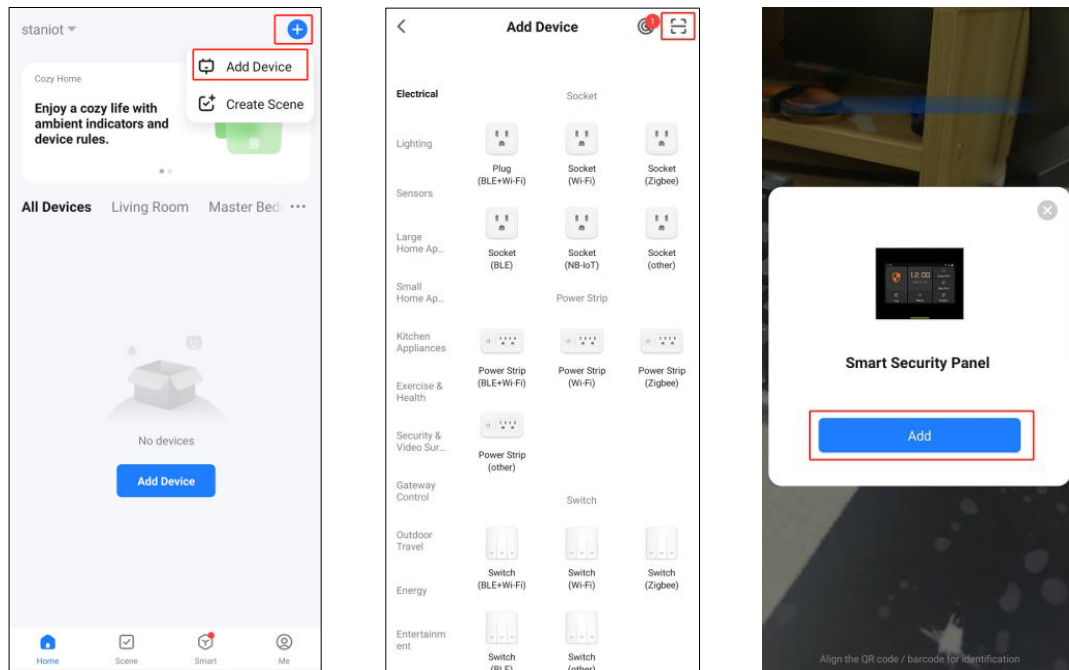

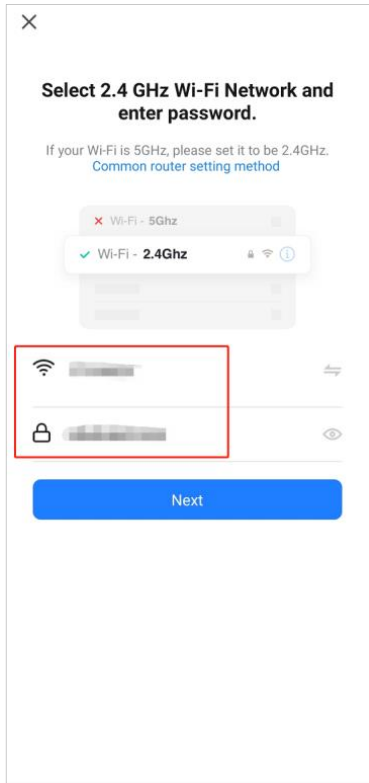

- 1) Click the "+" on the upper right corner of the interface and select "Add Device",
- 2) Click "☰" on the upper right corner to scan the QR code on the security panel (Step 1), then click "Add" Smart Security Panel.
- 3) Input the 2.4Ghz WiFi name and password, click "next".

(3) **On the Security Panel:** Press "➡" to enter "Step 2", click "Airlink (recommended)".

(4) The device will pop up "WiFi settings will be reset, please confirm". After clicking "OK", the device will prompt "Setting up, please wait".



(5) **On APP:** Click "Confirmation light is linking", and click "Blink Quickly", the pairing process will be complete within seconds.

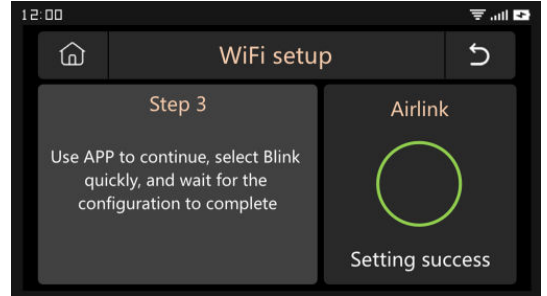
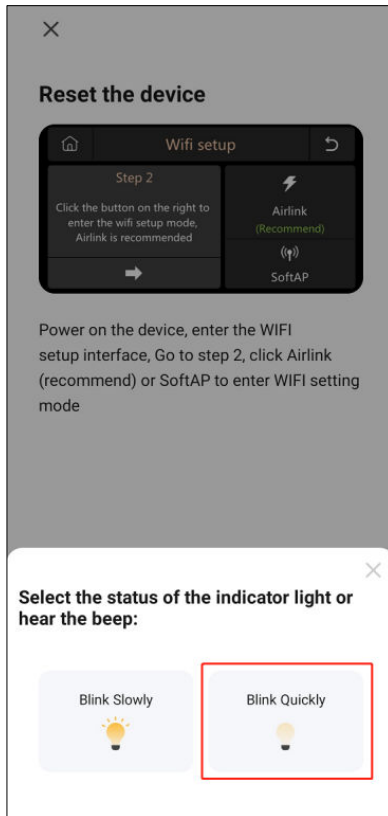
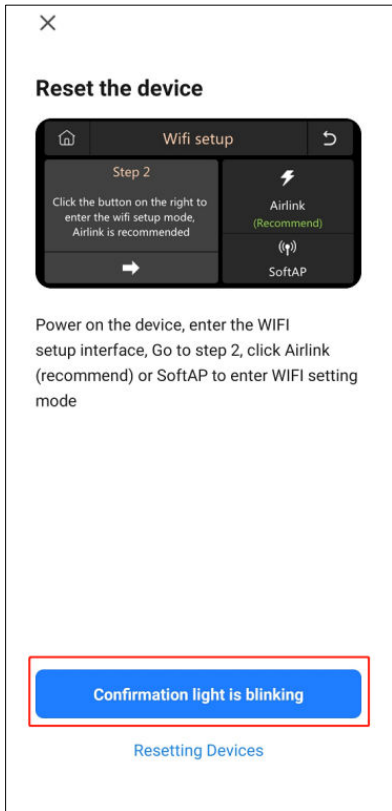

- (6) When the device is successfully connected to the APP, the device will give a voice prompt of "Setup successful". The APP will also show that the device has been added successfully.

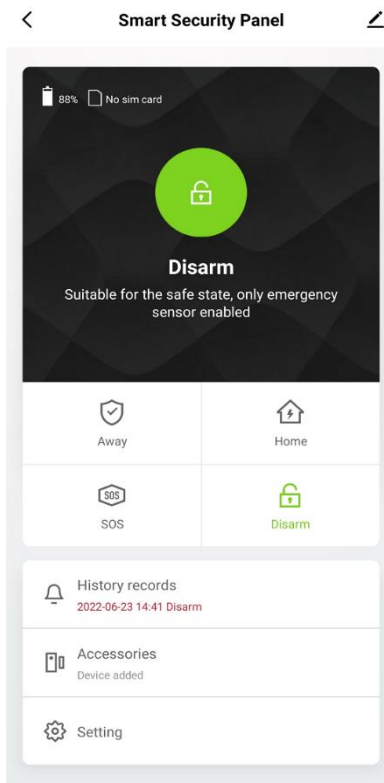
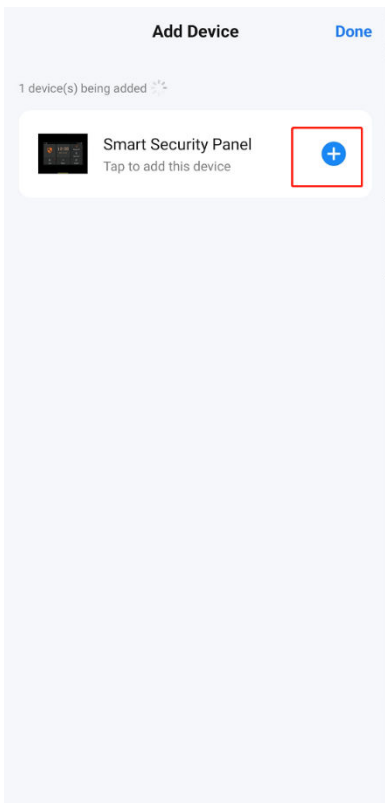



## 2.3 Settings on APP

### 2.3.1 Add Device

Click Accessories, press “+”, and then trigger the accessory to complete the pairing.

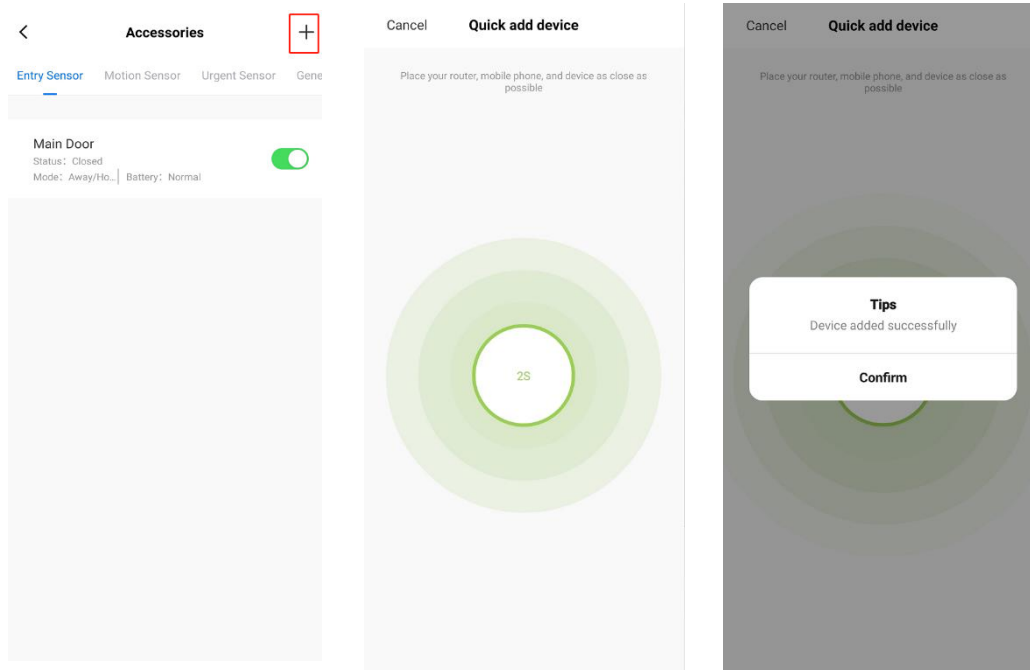

### 2.3.2 Rename Device

Accessory names can only be renamed on the APP, just press “Sub device name” to edit the name.

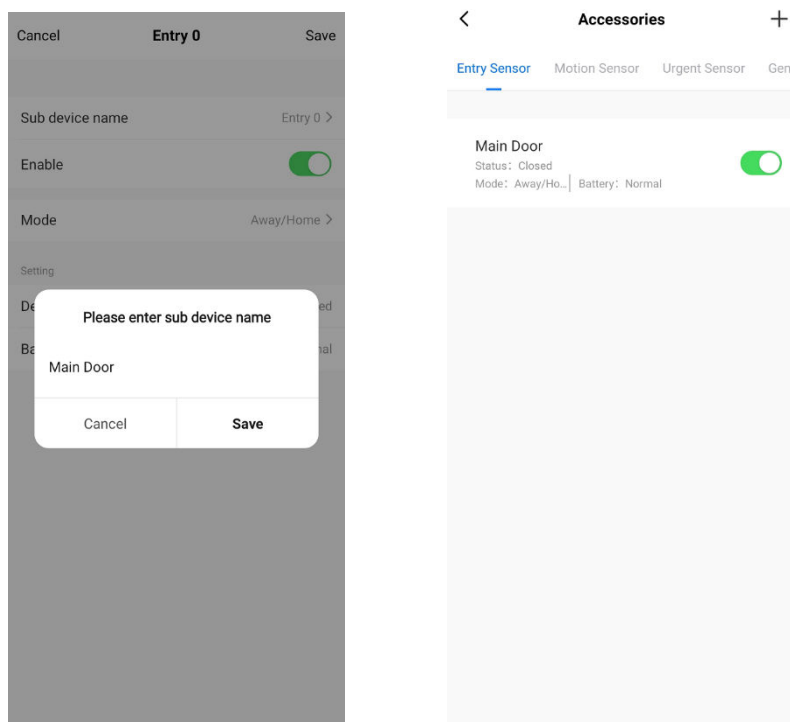

### 2.3.3 Share Device

A security panel can only be paired with one APP account, but you can share it with multiple family members to manage together.

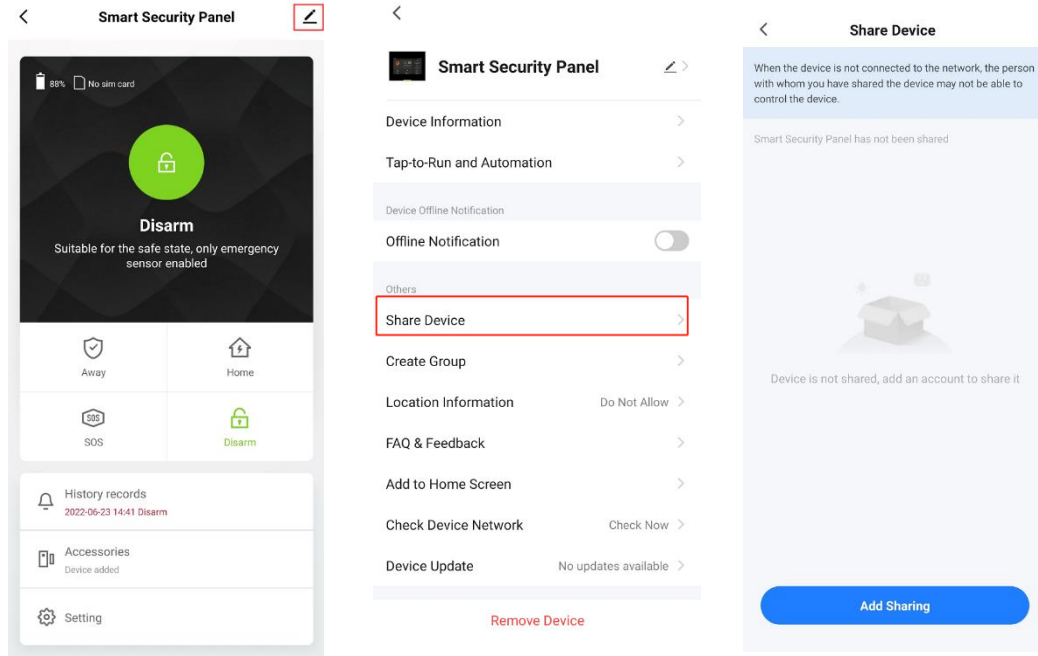

### 2.3.4 Other Settings

Press Setting, and can directly modify the settings in the security panel on the APP.

Through the APP, you can remotely control the security panel. You can also set the arm and disarm time, which is simple and convenient.

### III. Set up the Security Devices

#### 3.1 Security Panel

##### 3.1.1 Installation Diagram

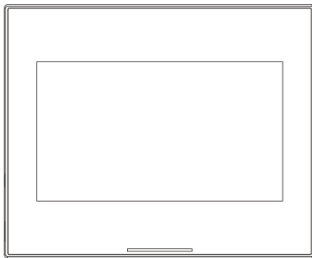

Security Panel×1



Wall Hanging Platex1

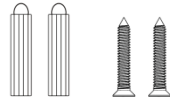

Screws×2

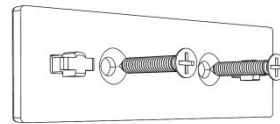

1. Install the hanging plate on the wall with screws.

**Note:** The screws must be all nailed to the wall, and the hanging board must be parallel.

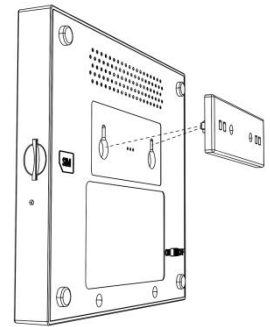

2. Align the hole on the back of the panel with the hanging plate and install it.

**Note:**

- 1) Installed in the center of the home to facilitate signal reception and transmission.
- 2) Install it closer to the WiFi router.
- 3) Avoid installing all devices on metal surfaces, as well as on load-bearing walls.

##### 3.1.2 Appearance Design

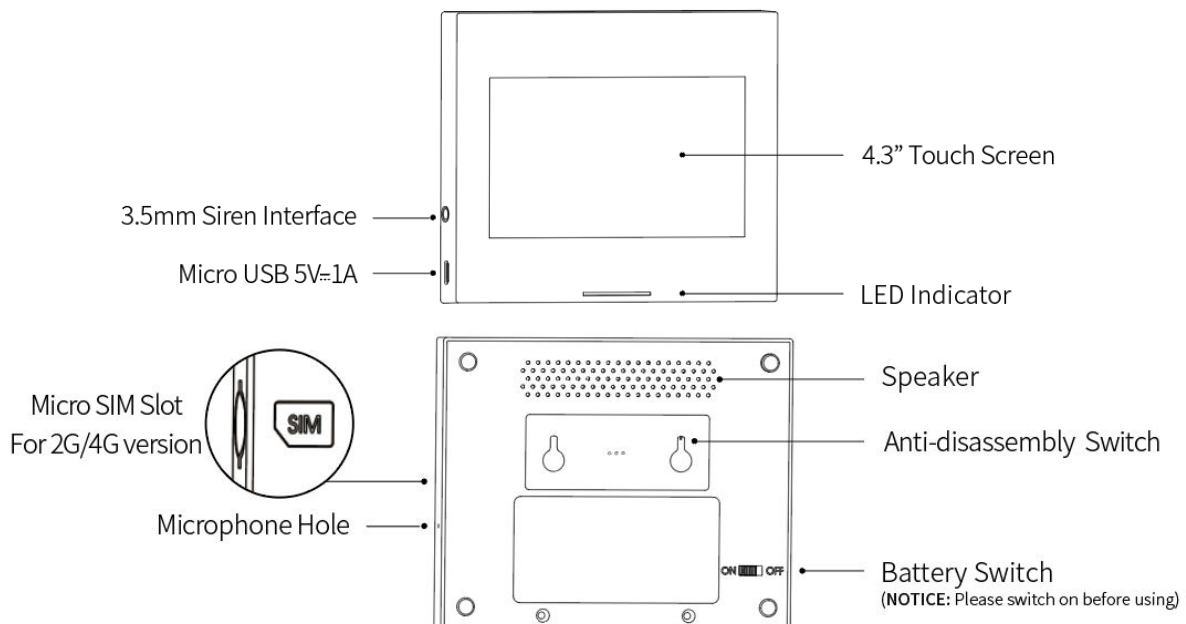

### 3.1.3 Indicator:

Color	Panel status	Flashing	Panel status
Red	Alarming	Yellow/Green	Delay Arming
Yellow	Armed	Red/Green	Delay Alarming
Green	Disarmed		

### 3.1.4 Alarm Modes

#### A. Security Panel Alarm Modes

- Away:** The security panel is in a monitoring state, when the accessories are triggered, the security panel will alarm.
- Home:** When the user is at home, in this mode, some areas can be monitored and alarms.
- Disarm:** The security panel cancels the monitoring state, and only the SOS button or the accessories set to "Always" mode can trigger the alarm.

#### B. Accessories Modes:

- Away/Home:** When the security panel is in the "Away" or "Home" state, the panel will alarm after the sensor is triggered. It is recommended that the outdoor sensor can be set to this mode.
- Away:** When the security panel is in the "Away" state, the panel will alarm after the sensor is triggered. It is recommended that the outdoor detector can be set to this mode.
- Always:** Regardless of the state of the security panel, any time the sensor is triggered, the panel will alarm. It is recommended to set this mode for gas leaks or smoke detectors, etc.
- Disabled:** The security panel will not respond to the alarm request of the sensor set in this mode.

#### Note:

You can choose which sensors are armed in Home and Away mode, or both, or always active. For example, if you want to avoid triggering the alarm when you are at home, you can set the specific sensor in Away mode. Then when you set the panel in "Home" state, the alarm will not be triggered, only in "Away" state, the alarm will be triggered.

## 3.2 Entry Sensor

### 3.2.1 Configure

On the Security Panel:

- Go to Menu--Accessories--Enter User Code (Default: 1234).
- Press Sensor--"+ " --Entry, then set the Mode, Delay, and Advanced settings.
- Press "+ Pair", then trigger the Entry sensor (Just separate the two parts).
- Paired successfully, rename the sensors on the APP.

### 3.2.2 Installation

The entry sensor should be installed on the door or window (see image).

- First, wipe the area on the door or window clean and apply double-sided tape to the bottom.
- The door sensor transmitter (large) and the door sensor magnet (small) should be installed separately. The **triangle marks** on the transmitter and the magnet should be facing each other, and the distance between the two is less than 0.6".
- When the door or window is opened after installation, the indicator light will be on for 2 seconds to indicate that the installation is complete.

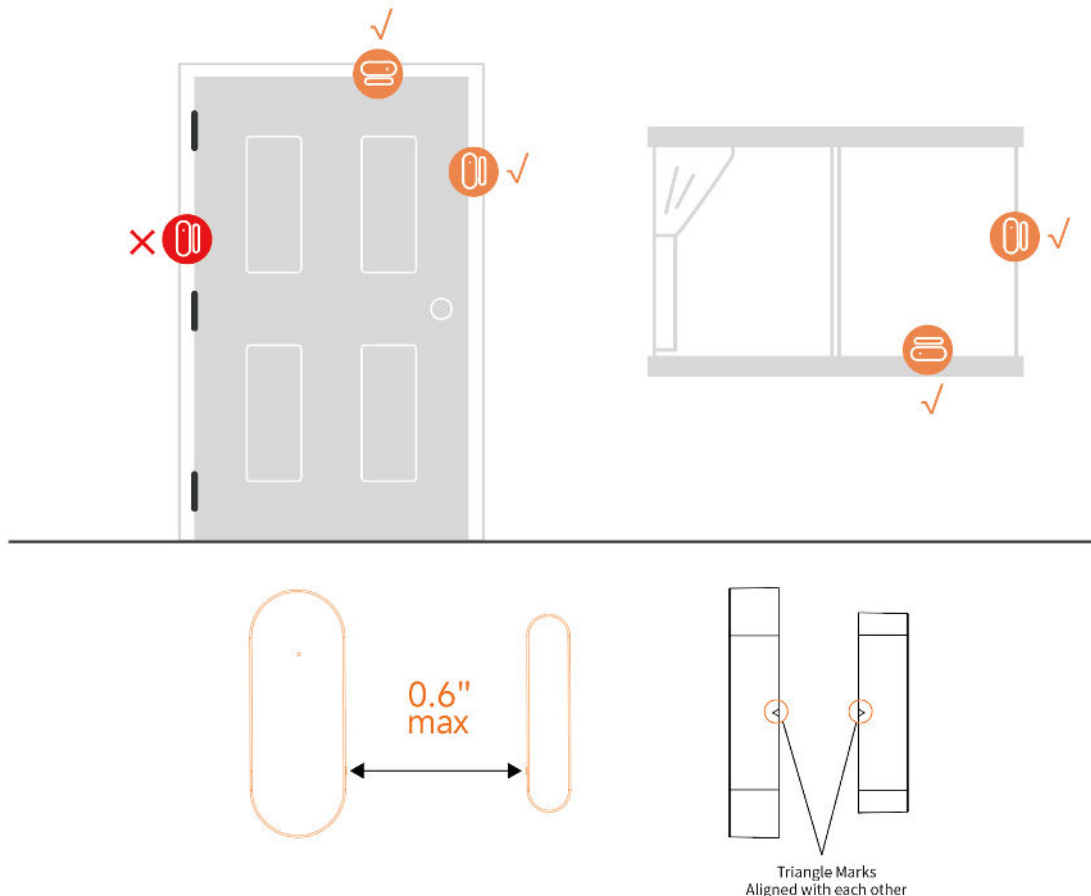

### 3.2.3 Battery Replacement

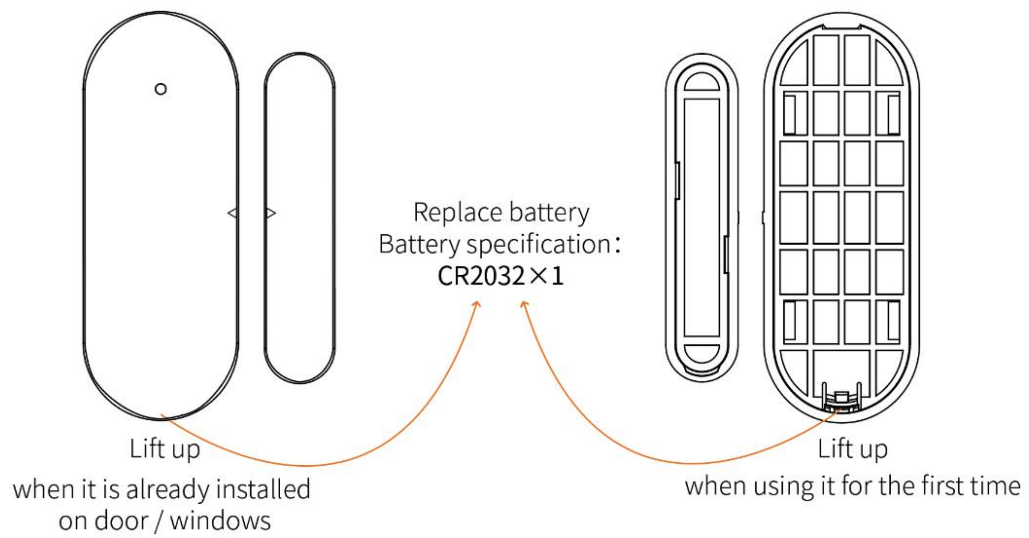

#### Door Sensor A

Battery specification: CR2032×1

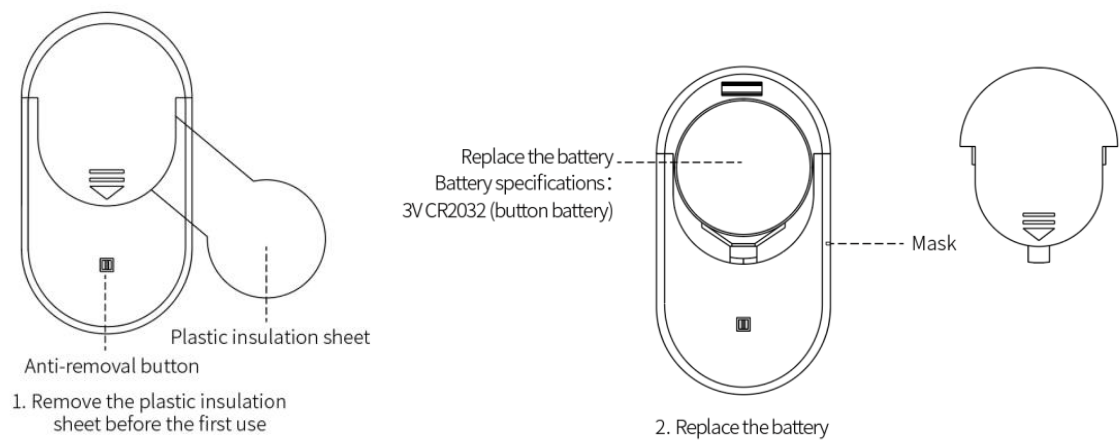

#### Door Sensor B

Battery specification: CR2032×1

## 3.3 Motion Sensor

### 3.3.1 Configure

On the Security Panel:

- Go to Menu--Accessories--Enter User Code (Default: 1234).
- Press Sensor--"+ " --Motion, then set the Mode, Delay, and Advanced settings.
- Press "+ Pair", then trigger the Motion sensor (Just wave your hands until the light is on).
- Paired successfully, rename the sensors on the APP.

### 3.3.2 Installation

- The recommended installation height is 79"-87" (2.0~2.2m) above the ground.
- Install it in a corner or on a flat wall, with no obstacles or blind spots.
- It should not be directly facing the cold and hot vents or cold and hot sources.
- To avoid false alarms, make sure your pets can't get close to it.

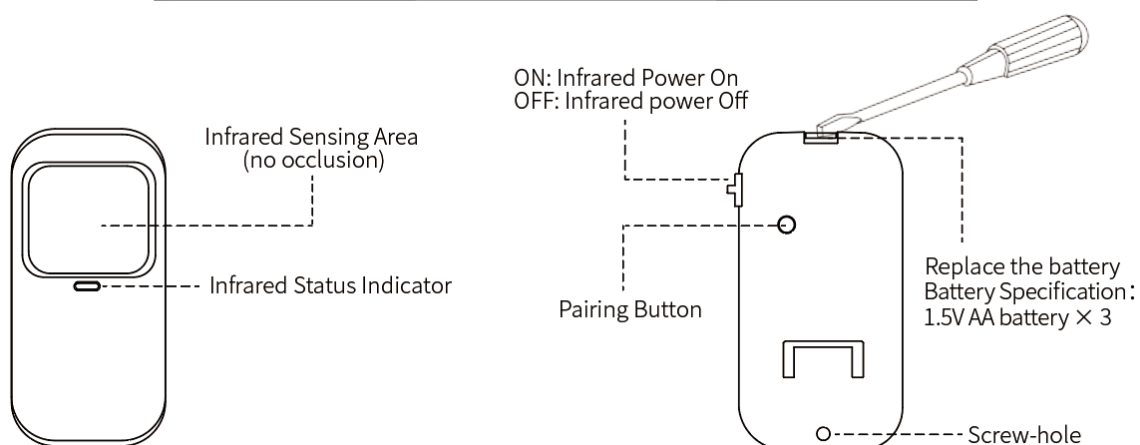
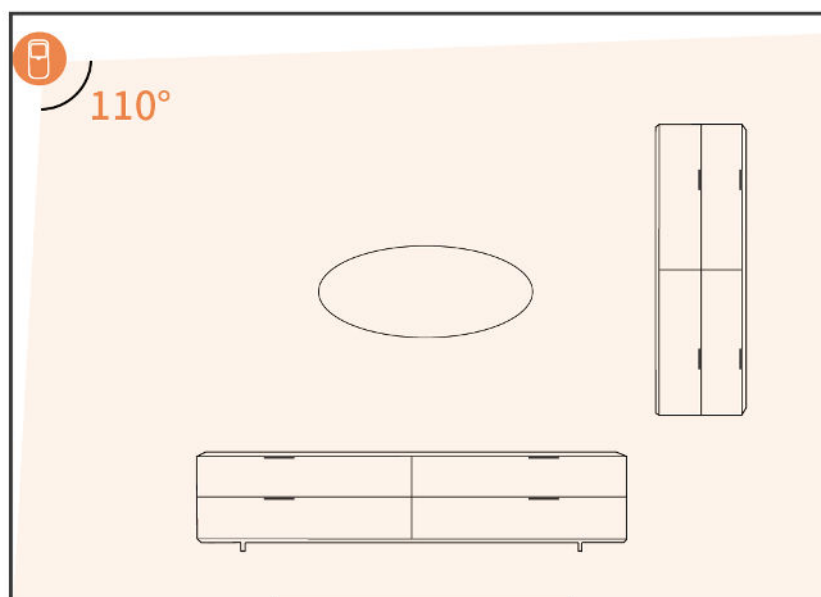

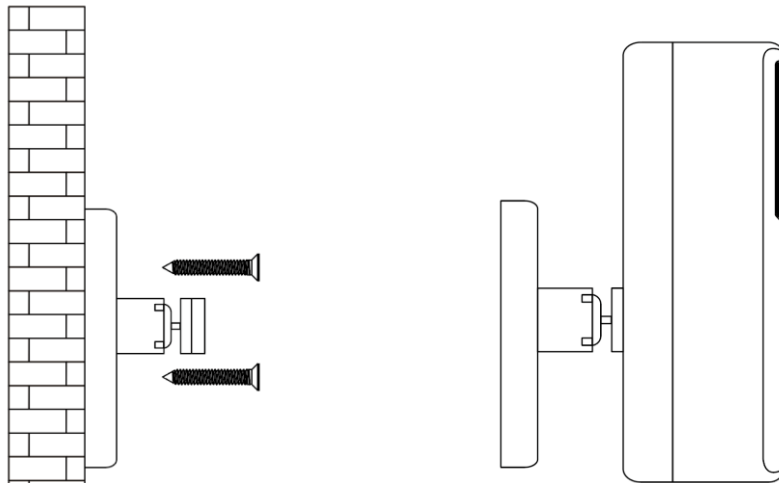

**Steps:**

- 1) Screw the base to the wall
- 2) Hang the motion sensor on the rotating shaft

### 3.4 Controller

#### 3.4.1 Configure

On the Security Panel:

- A. Go to Menu---Accessories---Enter User Code (Default: 1234).
- B. Press Controller
- C. Press “ + ”, then trigger the controller (Press any key).
- D. Paired successfully, rename the controller on the APP.

#### 3.4.2 Appearance Introduction

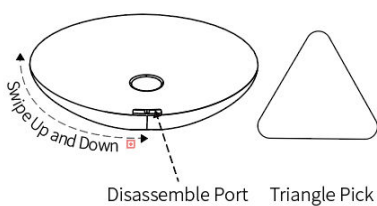
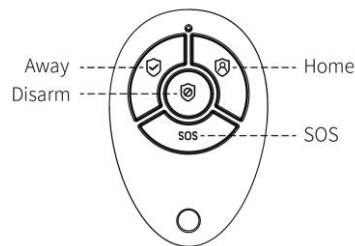

1. The user can use "Triangular Pick" to slide up and down along the side gaps at the disassembly opening repeatedly, and then break it apart.

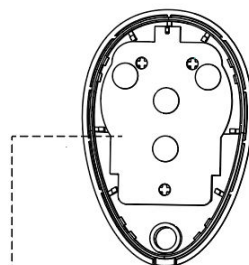

2. The battery is behind the PCB.

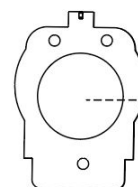

Replace the battery  
Battery specifications:  
3V CR2032

3. The user can re-install the remote control shell to use it when the user has completed the battery replacement.



## 3.5 Multifunction Button---Doorbell/SOS Button

### 3.5.1 Configure---Doorbell Button

On the Security Panel:

- A. Go to Menu---Accessories---Enter User Code (Default: 1234).
- B. Press Doorbell.
- C. Press "+", then press the doorbell button.
- D. Paired successfully, rename the sensors on the APP.

### 3.5.2 Configure---SOS Button

On the Security Panel:

- A. Go to Menu---Accessories---Enter User Code (Default: 1234).
- B. Press Sensor---"+ "---Urgent, then set the Advanced setting.
- C. Press "+ Pair", then trigger the SOS button.
- D. Paired successfully, rename the SOS button on the APP.

### 3.5.3 Install/Replace Battery

a. Open the cover:

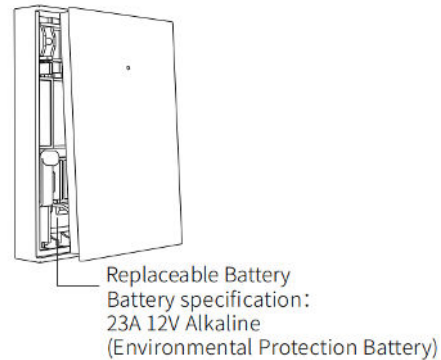
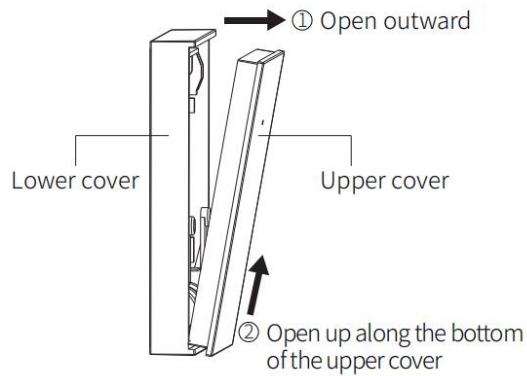

b. Close the cover:

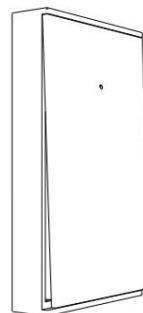
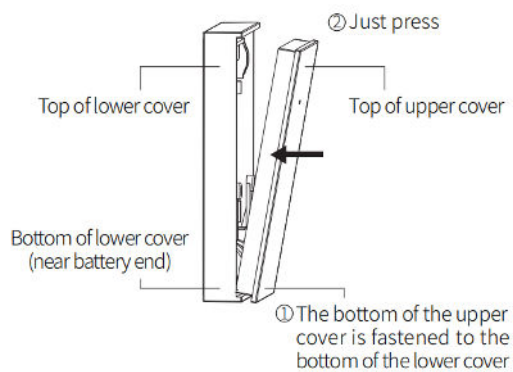

## IV. Learn to Use the Security Panel

### 4.1 Main Interface

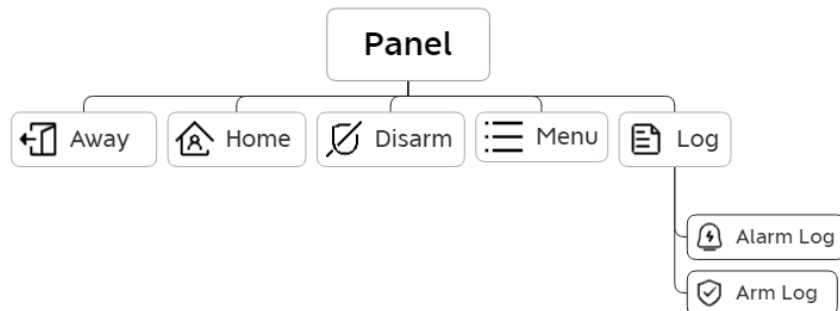
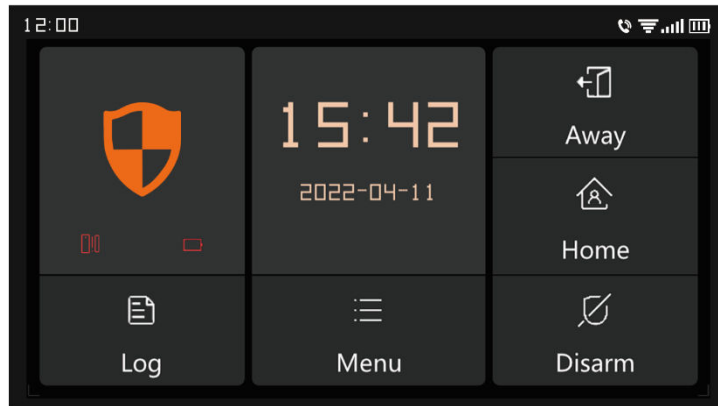

#### 4.1.1 System Status

Icon					
Status	The system is in alarm state	System is armed	System is disarmed	Accessories low battery	Door/Window opened

#### 4.1.2 Log

Alarm Log: View all alarm records, including Cause, Source, and Time.

Arm Log: View all arm/disarm records, including Action, Source Device, and Time.

**Note:** Support up to 160 Alarm records, and 80 Arm and disarm records.

## 4.2 Menu introduction

### 4.2.1 Accessory

#### A. Frame Diagram

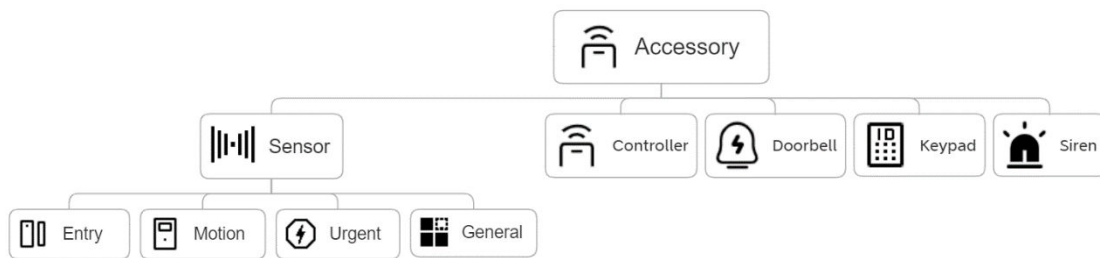
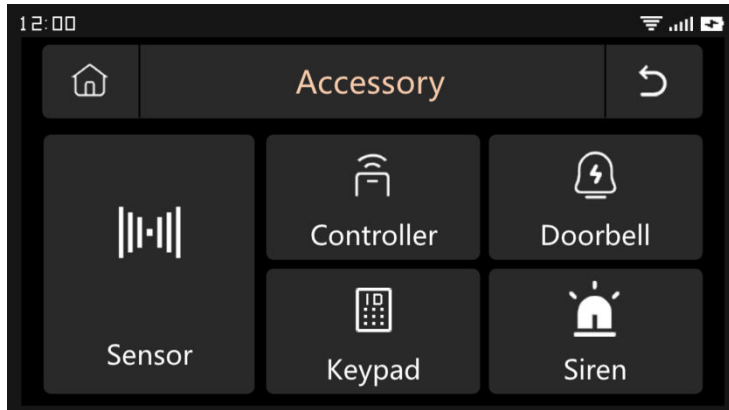

#### B. Sensor

Entry: Manage all the Entry sensors.

Motion: Manage all the Motion sensors.

Urgent: Emergency detectors such as SOS buttons, gas detectors, and smoke detectors, please add them here.

General: Other sensors or detectors, please add them here.

#### Note:

- 1) The security system supports the accessories with 433MHz, ev1527.
- 2) For the Entry sensors from another brand, please add it to "General"
- 3) Support up to 160 Sensors, 6 Controllers, 6 Doorbells, 6 Keypads.

## 4.2.2 Phone

### (1) Frame Diagram

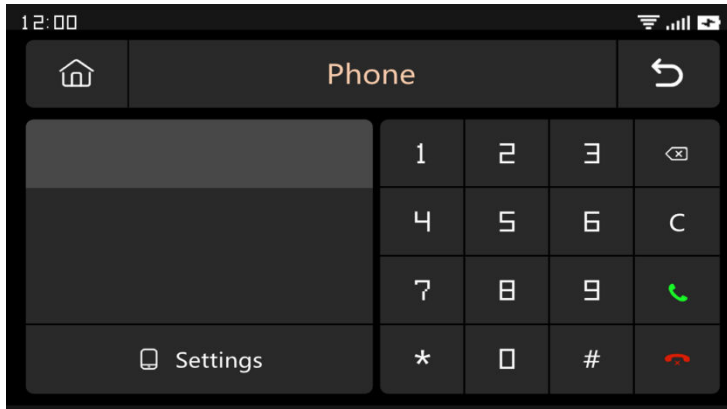

### (2) Emergency Number

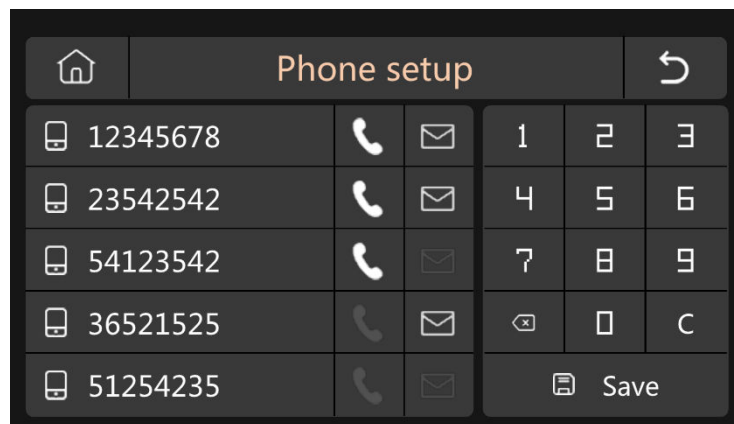

### Setup Example

Please light up the corresponding **Phone/SMS icon** according to your needs

- 1) **Phone Number Format:** If the phone number cannot be successfully dialed or sent a text message, please try adding the area code before the number: For example: 00XX, 0XX.
- 2) **SMS/Phone Alarm Rules:** After the alarm is triggered, the security panel will firstly send SMS messages in the order of the set numbers. After the text message is sent, the call will start from the first phone number. When the first number is dialed three times in a row and no answer, the second phone number will be dialed, and so on. If one of the phone numbers is answered, subsequent phone numbers will not be dialed.

(3) **Arm/Disarm Panel by SMS Command.**

(Firmware version should be 1.0.20 or above)

The SMS commands and panel actions were taken are as below:

No.	SMS Command	Action Taken by the Panel	Replied SMS
1	away arm	The panel will be in "Away" status	System armed!
2	stay arm	The panel will be in "Home" status	System armed!
3	disarm	The panel will be in "Disarm" status	System disarmed!

The panel will reply message to confirm the command is executed successfully.

**NOTE:** The panel only accepts SMS commands from the phone number set in the panel. (Menu->Phone->Settings), the SMS commands sent by other mobile numbers will be not recognized and no action will be taken.

## 4.2.3 Security

### (1) Frame Diagram

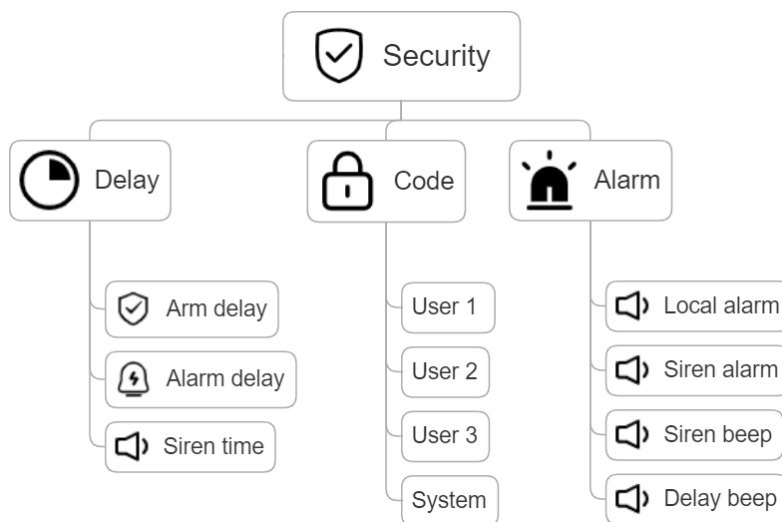
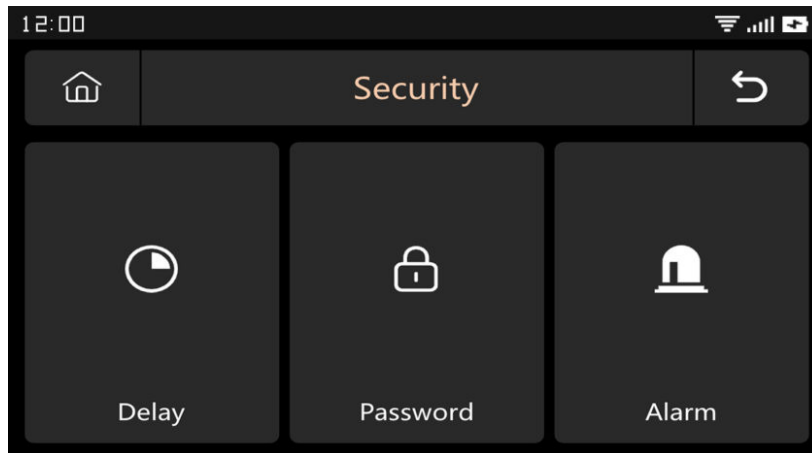

(2) Delay: Customize the countdown time when Alarm or Arm.

(3) Code:

- 1) User Code: Default user code is **1234**.
- 2) System Code: Default system code is **9876**.
- 3) Obfuscated Code: When entering the code, you can enter **5 to 8 digits** of the obfuscated code, as long as it contains the correct 4 digits in succession, it can be recognized as the correct code.
- 4) Password Validity Period: After selecting, you do not need to enter the password again **within 2 minutes** when the screen is on.

(4) Alarm:

Local Alarm: Select whether the panel emits an alarm sound.

Siren Alarm: Select whether the external signal emits an alarm sound

Siren Beep: Select whether the siren will beep when Arm/Disarm the panel.

Delay Beep: Choose whether to sound a beep when Arm or Alarm countdown.

## 4.2.4 Settings

### (1) Frame Diagram

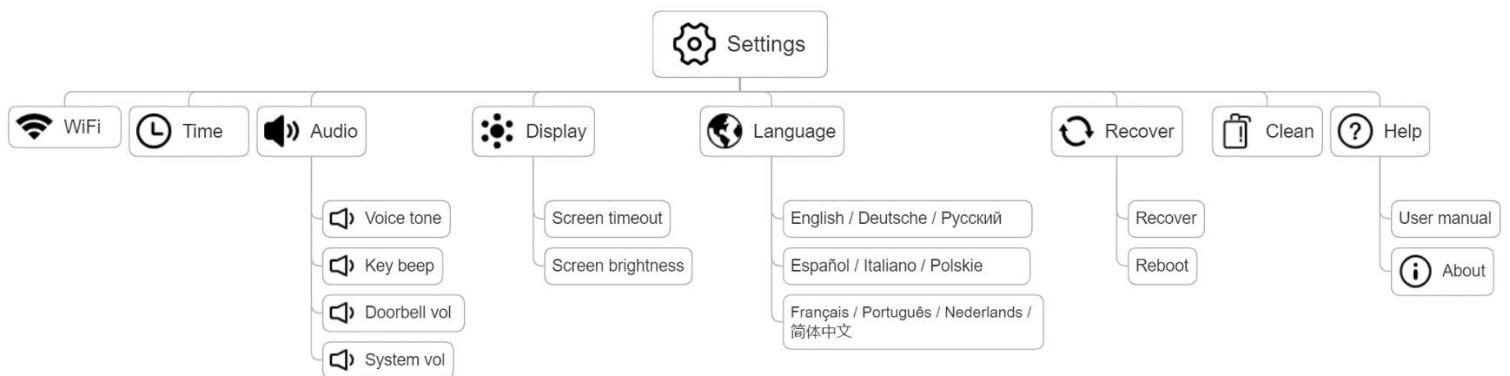
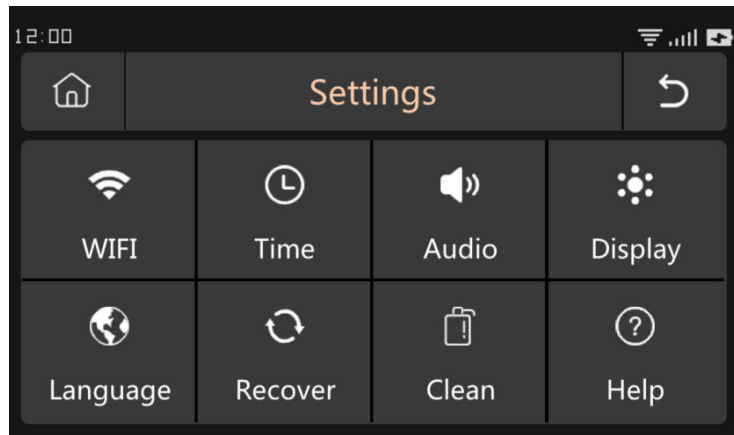

(2) WiFi: Connect the APP to configure the network or change the APP user.

(3) Time: Set the time and adjust the date display format.

(4) Audio: Adjust volume, turn on/off Key beep, Voice tone.

(5) Display: Set screen time and brightness.

(6) Language: English / Deutsche / Русский / Español / Italiano

Polskie / Français / Português / Nederlands / 简体中文

(7) Recover: Restart or reset the device.

(8) Clean: The screen will be black for 1 minute, easy to clean the screen.

(9) Help: User Manual, Device parameter information: Model, Version, IMEI, etc.

## V. Troubleshooting and Maintenance

Failure	The Reason	The Solution
Remote control malfunction	<ol style="list-style-type: none"> <li>1. Low battery</li> <li>2. The metal sheet of the battery compartment is in poor contact or is corroded</li> <li>3. The code is not paired with the panel</li> <li>4. Does not match the wireless parameters of the panel</li> </ol>	<ol style="list-style-type: none"> <li>1. Replace the battery of the same model</li> <li>2. Remove rust and dirt from metal sheets</li> <li>3. Re-pair with the panel</li> <li>4. Purchase accessories of the same type with technical parameters</li> </ol>
Door sensor failure	<ol style="list-style-type: none"> <li>1. Low battery</li> <li>2. The metal sheet of the battery compartment is in poor contact or is corroded</li> <li>3. The code is not paired with the panel</li> <li>4. Does not match the wireless parameters of the panel</li> <li>5. The door sensor transmitter and the magnet are installed too far</li> </ol>	<ol style="list-style-type: none"> <li>1. Replace the battery of the same model</li> <li>2. Remove rust and dirt from metal sheets</li> <li>3. Re-pair with the panel</li> <li>4. Purchase accessories of the same type with technical parameters</li> <li>5. Install the door sensor transmitter and the magnet close to each other</li> </ol>
Motion Detector failure	<ol style="list-style-type: none"> <li>1. Low battery</li> <li>2. The metal sheet of the battery compartment is in poor contact or is corroded</li> <li>3. The code is not paired with the panel</li> <li>4. Does not match the wireless parameters of the panel</li> <li>5. Incorrect angle</li> </ol>	<ol style="list-style-type: none"> <li>1. Replace the battery of the same model</li> <li>2. Remove rust and dirt from metal sheets</li> <li>3. Re-pair with the panel</li> <li>4. Purchase accessories of the same type with technical parameters</li> <li>5. Adjust the installation angle</li> </ol>
Security panel does not alarm	<ol style="list-style-type: none"> <li>1. The security panel is not armed</li> <li>2. Improper installation of accessories, too far away from the panel</li> <li>3. The accessory code does not match the panel</li> </ol>	<ol style="list-style-type: none"> <li>1. Arming the panel</li> <li>2. Adjust the position of accessories</li> <li>3. Re-pair with the panel</li> </ol>
The signal distance of the panel receiving accessories becomes shorter	<ol style="list-style-type: none"> <li>1. The main power is disconnected, and the backup power is insufficient</li> <li>2. There is interference from similar products nearby</li> <li>3. The panel receiving module is faulty</li> </ol>	<ol style="list-style-type: none"> <li>1. Check the power supply and restore the power supply</li> <li>2. Check the source of interference and remove it</li> <li>3. Contact customer service for repair</li> </ol>



No emergency call was made when the alarm was triggered	<ol style="list-style-type: none"> <li>1. The panel is not armed</li> <li>2. No emergency phone number is set</li> <li>3. Improper installation of accessories, too far away from the panel</li> <li>4. Encoding does not match</li> </ol>	<ol style="list-style-type: none"> <li>1. Arming the panel</li> <li>2. Re-set according to the instructions</li> <li>3. Adjust the position of accessories</li> <li>4. Re-pair with the panel</li> </ol>
WiFi network configuration failed	<ol style="list-style-type: none"> <li>1. 2.4GHz WiFi is not connected</li> <li>2. The current router is not compatible with quick configuration</li> <li>3. Damaged WiFi module</li> </ol>	<ol style="list-style-type: none"> <li>1. Connect to 2.4GHz WiFi</li> <li>2. Adopt panel WiFi hotspot configuration mode</li> <li>3. Contact customer service for repair</li> </ol>
Entry opened warning is invalid	<ol style="list-style-type: none"> <li>1. Door sensor pairing error</li> <li>2. The door sensor switch code does not match the panel</li> <li>3. Wrong alarm type is set</li> </ol>	<ol style="list-style-type: none"> <li>1. The door opening code needs to be paired correctly</li> <li>2. The accessories are non-certified devices</li> <li>3. Set the alarm type as main door alarm and window alarm</li> </ol>

## VI. Hazardous Substance Declaration

Component Name	Harmful substance					
	Lead (Pb)	Mercury (Hg)	Cadmium (Cd)	Hexavalent chromium (Cr(VI))	Polybrominated biphenyls (PBB)	Polybrominated diphenyl ethers (PBDE)
Metal parts	0	0	0	0	0	0
Plastic parts	0	0	0	0	0	0

## VII. Warranty Rules

- (1) Please contact our after-sales service for any failure caused by the product itself during the warranty period.
- (2) The goods are guaranteed for one year from the date of sale, and the warranty service is only valid under normal use.
- (3) Damage caused by the use environment not meeting the requirements of this product is not covered by the warranty.
- (4) Product damage caused by man-made and force majeure is not covered by the warranty.